

Vertical Movement Joints



At vertical movement joints, the use of plastic debonding sleeves on plain-ended wall ties allows the masonry to expand or contract whilst restraining against lateral wind loads.

Wincro WDS debonding sleeves are used with all relevant Wincro plain-ended wall ties (all prefixed WTP~).

Wincro recommends that debonding sleeves be installed with a 10mm gap at the end to allow for expansion.

All structures are subject to movement after construction because of influences ranging from temperature to ground movement and differential settlement. It is essential, therefore, that provision for movement is made at the design stage and this takes into account the overall stability of the structure.

Cavity Wall with Vertical Movement Joint in Brickwork

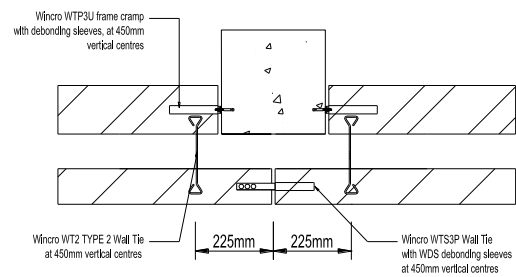
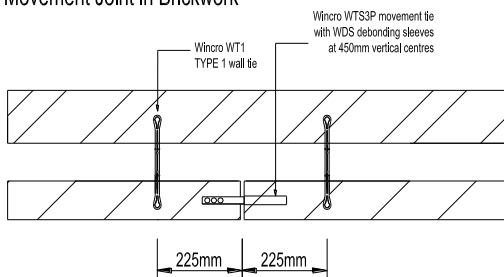

Intermediate Column with Vertical Movement Joints in both Brickwork and Blockwork

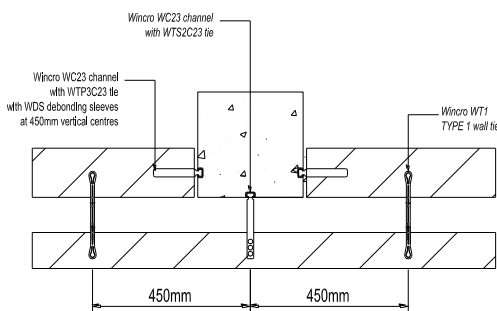

Intermediate Column with Vertical Movement Joints in Blockwork

External Corner with Fully Bonded Brickwork

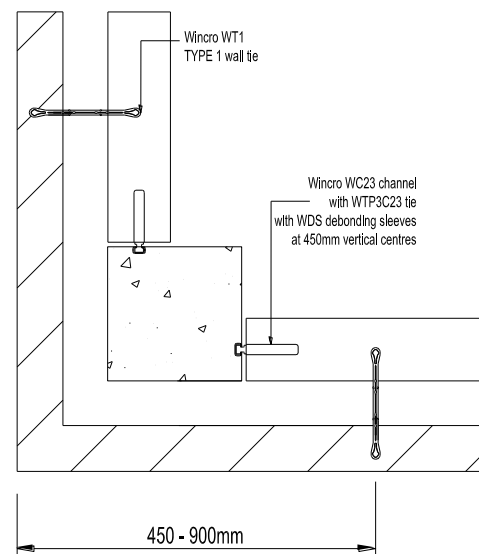

GENERAL

All Wincro products are produced from Type 1.4301 (304) Stainless Steel u.n.o. and are generally produced from sheared plate. As with all similar industrial fabrications, these may present sharp edges and suitable personnel protective equipment should be worn at all times during handling and installation. In all cases, installation should be entrusted to appropriately qualified/experienced persons.

All contact between dissimilar metals must be isolated using isolation patches/washers.

All bolts specified must be installed and torqued to Manufacturers Recommendations / Guidelines.

The Construction applications and details provided in this guide are indicative only.