

The Wincro range of cavity wall ties are suitable for buildings of all heights and should be selected after consulting the relevant technical documents (see www.wincro.com).

Available in a wide variety of lengths and suiting cavities from 50mm upwards, all Wincro cavity wall ties can use the WIC plastic insulation-retaining clip for partially insulated cavities.

DENSITY & POSITIONING OF TIES

For walls in which both leaves are 90mm or thicker, ties should be used at not less than 2.5 per square metre (900mm horizontal x 450mm vertical centres). This spacing may be varied when required by the Building Regulations. Ties should be evenly distributed over the wall area, except around openings, and should preferably be staggered. At vertical edges of an opening, unreturned or unbonded edges, and vertical expansion joints, additional ties should be used at a rate of one per 300mm height, located not more than 225mm from the edge.

LENGTH OF TIE & EMBEDMENT

Wall ties should be carefully selected to ensure they achieve a 50mm minimum embedment of tie end into the mortar. To allow for site tolerances, Wincro recommend choosing ties to provide a 62.5mm embedment. The table below recommends lengths of tie to suit various cavity widths.

Cavity Width (mm)	Tie Length (mm)
50-75	200
76-100	225
101-125	250
126-150	275
151-175	300
176-300	Two Part Tie

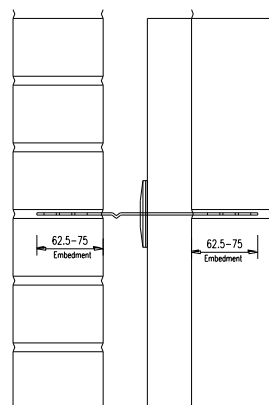

INSTALLATION GUIDE

Wall ties are important to the stability of masonry panels and Wincro recommend the following guidelines be followed when installing wall ties.

- Both leaves of the cavity wall should be built simultaneously to eliminate any risk of injury from protruding ties.
- Wall ties should always be pressed down firmly into fresh mortar, be fully surrounded and have a slight fall towards the outer leaf to avoid damp. Ties should never be slid into a joint.
- The drip section of the tie should always point downwards and be ideally positioned centrally within the vented (air) cavity.
- Ties should **never** be bent on site to aid installation.

HEALTH AND SAFETY

To help eliminate the risk of injury on site, all Wincro cavity wall ties feature safety ends. Wherever possible, it is advised that both leaves of a cavity wall are built simultaneously to eliminate the risks associated with protruding ties. Site managers should make all workers and visitors aware of this risk.

GENERAL

All Wincro products are produced from Type 1.4301 (304) Stainless Steel u.n.o. and are generally produced from sheared plate. As with all similar industrial fabrications, these may present sharp edges and suitable personnel protective equipment should be worn at all times during handling and installation. In all cases, installation should be entrusted to appropriately qualified/experienced persons. All contact between dissimilar metals must be isolated using isolation patches/washers. All bolts specified must be installed and torqued to Manufacturers Recommendations / Guidelines. The Construction applications and details provided in this guide are indicative only.